

**STRAIGHT PLUG EZ-FIT**

**CABLE 1/2" HELICAL**

**R164.037.000**

Series : QN

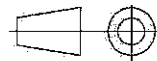
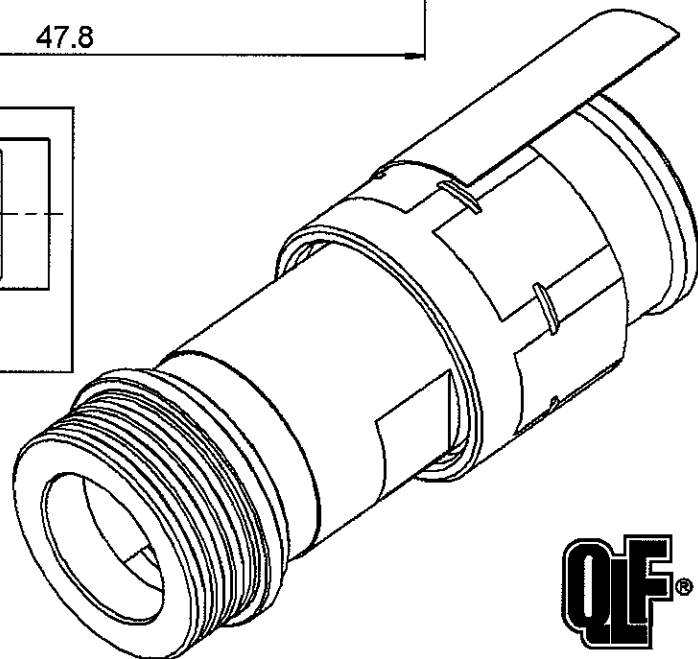
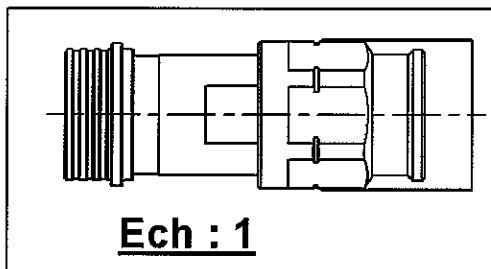
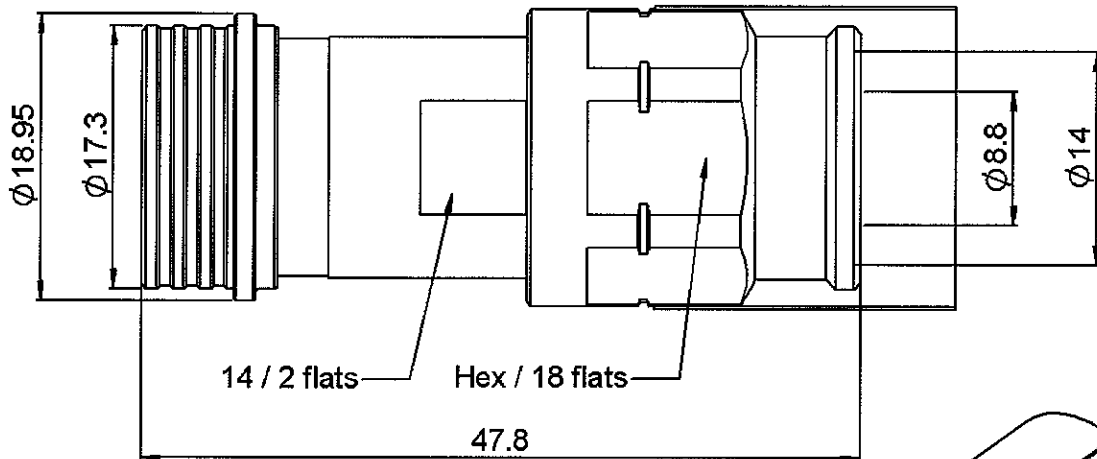

All dimensions are in mm.

COMPONENTS	MATERIALS	PLATINGS (µm)
BODY	BRASS	BBR 0.5 OVER SILVER 3
CENTER CONTACT	BERYLLIUM COPPER	SILVER 5 PASSIVATED OVER COPPER 0.5
OUTER CONTACT	BERYLLIUM COPPER	GOLD 0.3 OVER CHEMICAL NICKEL
INSULATOR	PTFE	
GASKET	EPDM	
OTHERS PARTS	BRASS	BBR 2
-	-	-
-	-	-

Issue : 0520 C

In the effort to improve our products, we reserve the right to make changes judged to be necessary.



**STRAIGHT PLUG EZ-FIT**

**R164.037.000**

**CABLE 1/2" HELICAL**

Series : QN

**PACKAGING**

Standard	Unit	Other
1	-	Contact us

**SPECIFICATION**

**ELECTRICAL CHARACTERISTICS**

Impedance		<b>50</b> Ω
Frequency		<b>*0-6</b> GHz
VSWR	<b>1.05 +</b>	<b>0.025</b> x F(GHz) Maxi
Insertion loss		<b>0.048</b> √F(GHz) dB Maxi
RF leakage	<b>- (</b>	<b>** 90</b> - F(GHz) dB Maxi
Voltage rating		<b>1400</b> Veff Maxi
Dielectric withstanding voltage		<b>2500</b> Veff mini
Insulation resistance		<b>5000</b> MΩ mini

**CABLE ASSEMBLY**

Stripping	a	b	c	d	e	f
mm	5.50	5.00	11.5	0.00	0.00	0.00

Assembly instruction : **NA**

Recommended cable(s)  
 HCF 1/2" Cu2Y  
 FSJ4RN-50B  
 FSJ4-50B - 1/2"  
 FSJ4P-50B-4 - 1/2"

Characteristics indicated on this data sheet are those that can be achieved with the highest performance cable. Intrinsic limitations of the cable may diminish the performance of the assembly

**Cable retention**

- pull off **500** N mini  
 - torque **NA** N.cm

**MECHANICAL CHARACTERISTICS**

Center contact retention		
Axial force – Mating end	<b>68</b>	N mini
Axial force – Opposite end	<b>68</b>	N mini
Torque	<b>NA</b>	N.cm mini

**TOOLING**

Part Number	Description	Hexagon
.	.	.
R282.010.050	STRIPPING TOOL	
R282.303.220	TORQUE SPANNER .708 in 84.075 in.lb	

Recommended torque		
Mating	<b>NA</b>	N.cm
Panel nut	<b>NA</b>	N.cm
Clamp nut	<b>950</b>	N.cm
A/F clamp nut	<b>18.000</b>	mm

Mating life	<b>100</b>	Cycles mini
Weight	<b>47.900</b>	g

**OTHERS CHARACTERISTICS**

\* Usable 0-11GHz  
 \*\*RF Leakage: -80dB min 3<F<6GHz  
 \*\*\*PIM 3 : -112dbm (2 x 20W at 1.8GHz)

**ENVIRONMENTAL**

Operating temperature	<b>-55/+125</b>	° C
Hermetic seal	<b>NA</b>	Atm.cm3/s
Panel leakage	<b>NA</b>	

Issue : 0520 C

In the effort to improve our products, we reserve the right to make changes judged to be necessary.



**STRAIGHT PLUG EZ-FIT**

**CABLE 1/2" HELICAL**

**R164.037.000**

Series : QN

HEATSHRINK SLEEVE

BRAID CLAMP NUT

GASKET

BODY

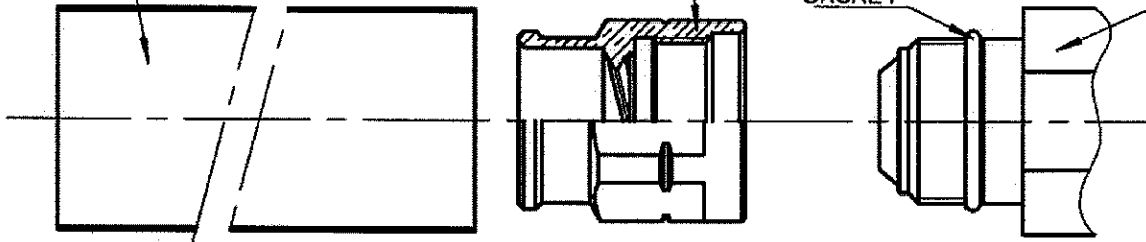

1

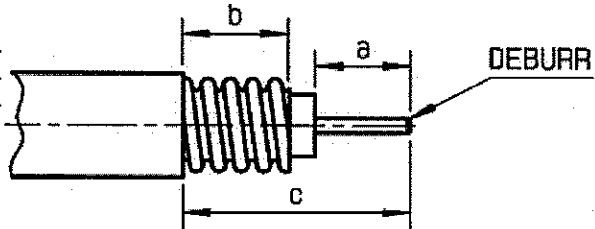

3

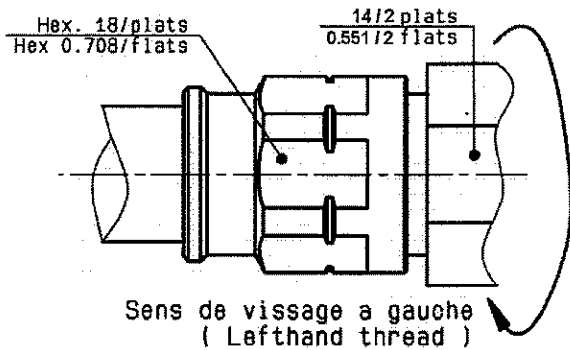

2

- Slide the heatshrink sleeve onto the cable.
- Screw manually the braid clamp nut onto cable outer conductor until stop.

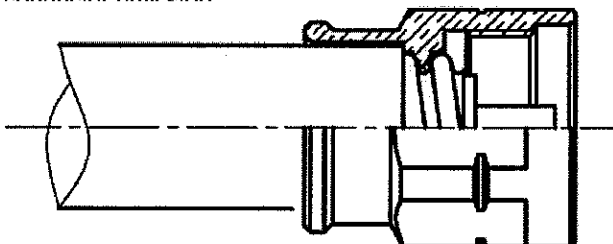

4

Shrink the heatshrink sleeve

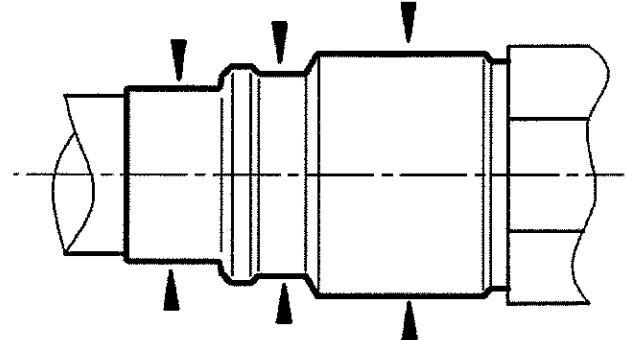

Issue : 0520 C

In the effort to improve our products, we reserve the right to make changes judged to be necessary.

